

Fitting Instructions - METAL GATES

ARCHITECTURAL



HaspLock™

These instructions relate to a left-hand hinged Hasp. For a right-hand hinged Hasp, see notes under Diagram C overleaf.

Preparation: Before installing this D&D HaspLock™, ensure:

- The maximum gap between the gate posts does not exceed 4" (100mm)
- The Hasp component has at least 2" (50mm) clearance below the lock assembly so the hasp hangs vertically when open. See Diagram B.
- The HaspLock is mounted in a position so that it can be opened from the inside, if needed.

Tools required: Welder, grinder, Phillips No.2 screwdriver (hand & powered types), level, clamps, pencil, grease.

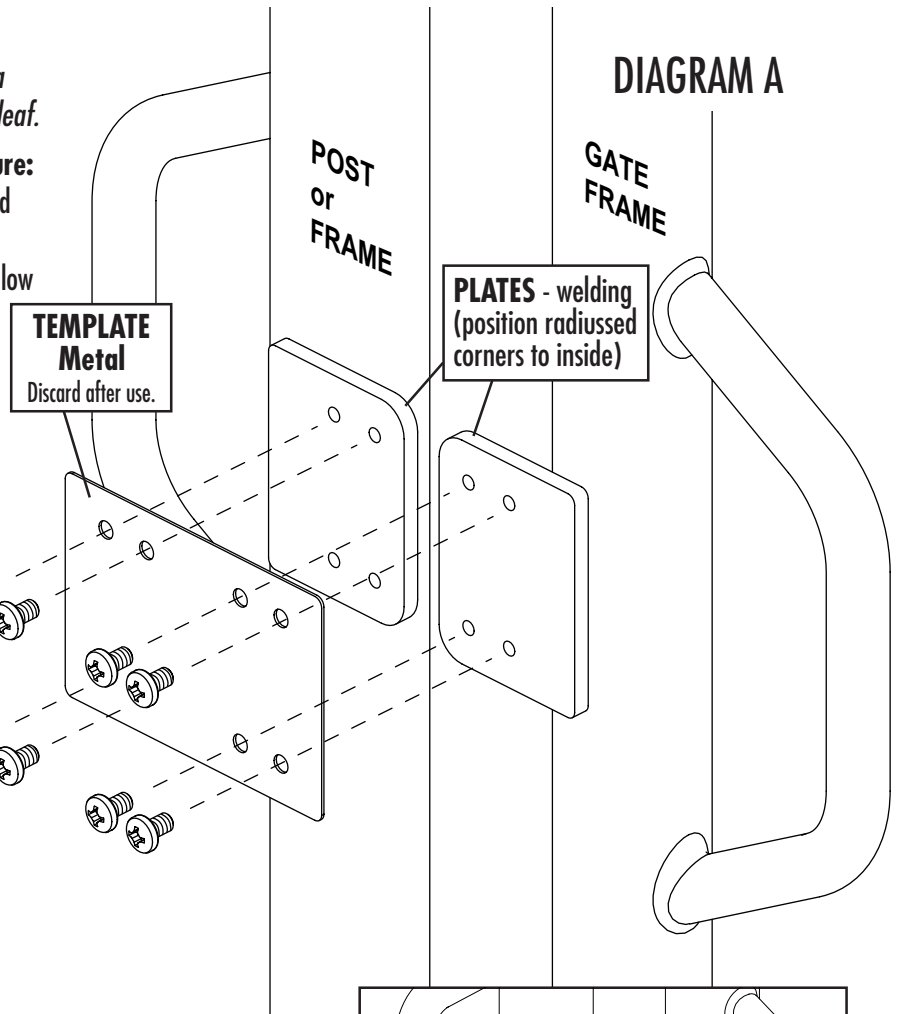
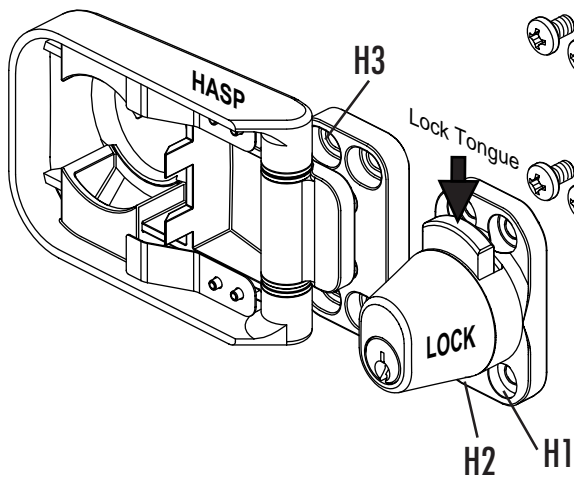

1. Temporarily screw the metal Template to the two Plates with the eight screws provided, ensuring the large, rounded corners of the Plates face inwards, as shown.

2. Pull the gate into its closed position (securing any drop bolts that may be attached). It is important that the gate be in its fully closed position to ensure the Plates are - ultimately - attached and aligned on the gate correctly.

3. Place the Template assembly equally across the gate frames (or post), and roughly mark the Template areas against the gate in preparation for welding. Back off any screws that touch the gate frames. If more than two screws on one side touch then place 1/8" (3mm) of washers (not supplied) under the screw head and re-tighten.

4. To ensure a clean weld, grind off any coatings on the gate frames/posts and Plates.

5. Line up the Template assembly on the gate again, ensuring that it is both level and evenly located across the gate frames. Clamp the assembly in place and weld the Plates onto the gate frames.

6. Unscrew the Template and discard. Apply a suitable rust-preventative coating to the welded areas. Add grease to the screws to ensure an easy removal of the HaspLock in the future. Attach the HaspLock as shown using the same screws. It is advisable to attach the Lock first (with the Lock Tongue facing upwards - see Diagram A above) by securing the screws in holes H1 and H2. Secure the top screws in the Lock after inserting the key and rotating clockwise to retract the Lock tongue.

7. Secure the Hasp by inserting a screw through hole H3 first (important). When this is done, secure the Hasp to the Plate with all four screws. Ensure the Hasp is centered over the Lock. Re-adjust if required and then tighten firmly.

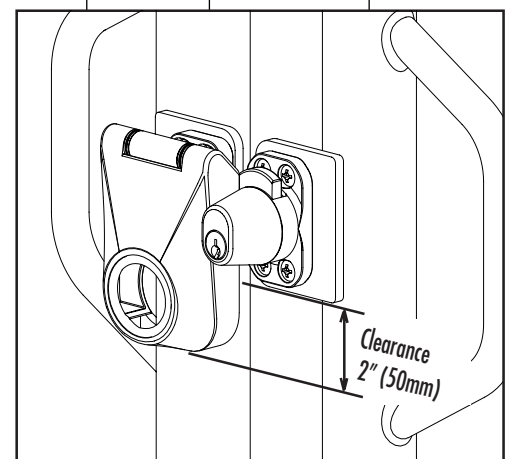
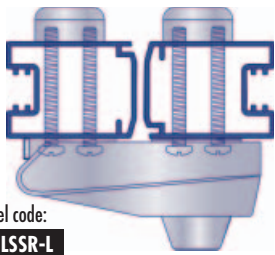

DIAGRAM B

OTHER STANDARD D&D HASPLOCK™ MODELS...



Model code:
FHLSSR-L

Regular model as used on door or gate frames.

Single-Hinge model as used on doors or gates. Note that hinging flexibility allows installation to different door frame configurations.

Model code:
FHLSSH-L

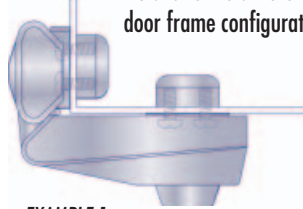

EXAMPLE 1

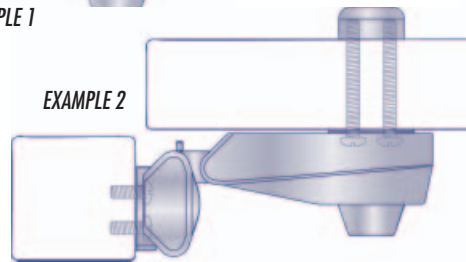

EXAMPLE 2

ARCHITECTURAL



HaspLock™

Model code:
FHLSSDH-L

Double-Hinge model is ideal for those difficult applications and awkward configurations.

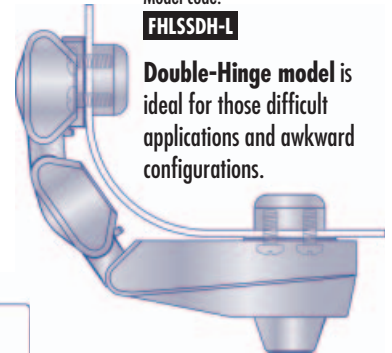

DESIGN YOUR OWN LOCK?

Custom-made HaspLocks for all types of security situations...

D&D HaspLock™ can be custom-built with as many "hinges" (i.e. coupling extensions) as necessary to complete an application. Almost any door, gate or other security application can be overcome, no matter how difficult. For example, extra hinges may be required to wrap around an unusual or awkward shape such as a vending machine or severely offset doors, gates or toolboxes. Ask your supplier for details on how to order a custom-built, multi-hinged HaspLock.

LEFT- OR RIGHT-HAND HINGED HASP?

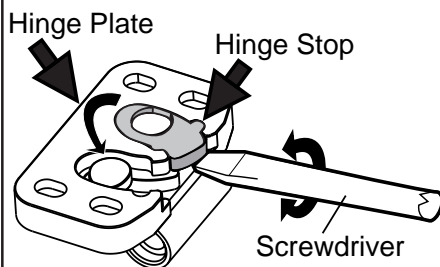

The D&D HaspLock™ can be reversed to become a right-hand hinged hasp by extracting the black Hinge Stop and inserting it in the opposite slot within the Hinge Plate.

DIAGRAM C

REPLACE THE LOCK CYLINDER?

To re-key or upgrade to a higher security lock cylinder...

1. Remove screw from back plate.
2. Place lock body as shown, allowing at least 3/16" (4mm) clearance under the lock to allow the back plate to eject.
3. Tap lightly on the face of the cylinder with an OD5/8" (16mm) max. plastic punch or similar soft punch.

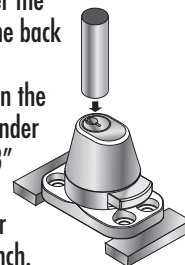

MAINTENANCE: Lubricate the D&D HaspLock™ using only graphite powder. DO NOT use oil or grease.

WARRANTY & LIMITATION OF LIABILITY

D&D Technologies' ("D&D") products are warranted to be free of defects in materials and workmanship to the original purchaser for as long as he/she owns the product. This product will operate properly, and warranty is valid, only if installed in accordance with the instructions and specifications shown. If a structural defect appears, the original purchaser may return the item, freight prepaid, together with proof of purchase to D&D or its approved international agents. D&D or its agent will, at their discretion, repair or replace the defective item or part without charge to the purchaser. THIS WARRANTY SHALL NOT APPLY WHEN the product has been tampered with, when repairs or attempted repairs have been made by unauthorized persons, where the item has been subjected to misuse, abuse, accident or damage in transit, or where the installer has not followed the instructions set out during installation, operations, or Maintenance Requirements. IN NO EVENT SHALL THE COMPANY BE LIABLE FOR ANY INCIDENTAL OR CONSEQUENTIAL DAMAGES. No warranty is given other than that set out above. No other express or implied warranties (including statutory warranties) apply, other than warranties which may not be legally excluded.



D&D Technologies

AUSTRALIA: Unit 6, 4-6 Aquatic Dr, Frenchs Forest NSW 2086
USA: 7731 Woodwind Drive, Huntington Beach, CA 92647

HASP0000040PA

*Inst_D&DHasp_gate (20/6/05)